



Tuesday 2 March

Dear Stakeholder,

Proposals for a new special school adjacent to Marlwood School in Alveston

I am writing to you on behalf of ISG, the Department for Education (DfE) and Enable Trust, working in partnership with South Gloucestershire Council, to let you know about plans to construct a new special school on land adjacent to Marlwood School, in Alveston, and to invite you to participate in consultation on the proposals.

The Two Bridges Academy will be a new school for children and young people with complex Special Educational Needs and Disability (SEND). It will provide places for 112 pupils (aged 2 – 19), including pupils with severe learning difficulties and autism, as well as those with profound, and multiple learning difficulties. It will be an 'all through' school providing places from nursery to 6th Form, with approximately 90 specialist staff.

As the site is located in the Green Belt, various documents are being prepared to justify its location and these will be submitted in support of the planning application. The site for the school has been chosen because it will be well positioned to meet the need for the school. Co-locating the new Academy with Marlwood School also provides educational and social opportunities for inclusiveness, collaboration and enhanced provision for both mainstream and special school pupils.

Two Bridges Academy will be funded and delivered by the DfE as part of the Free Schools Programme and will be run by Enable Trust, a local specialist education academy trust who run New Siblands school in Thornbury and Culverhill school in Yate.

The brief for the school is for 'Net Zero Carbon', so sustainability is a key factor in the design and operational approach. Some of the school's specialist facilities will be available for local community use and hire outside school hours.

ISG and its design and planning team are working towards submitting a full planning application to South Gloucestershire Council in late spring 2021 following consultation feedback from key stakeholders and neighbours.

The proposal is currently in the design and development stage, with pre-application discussions underway with South Gloucestershire Council as the Local Planning Authority.

Have your say:

We would like to invite your comments on the proposals, which will be available to view at www.twobridgesacademy.co.uk from 3 March 2021. Also attached to this letter are artist's impressions of the school together with a location map and a site master plan.

To provide feedback, you can complete the online form which will be available once the website launches on **3 March**. We kindly request that comments are returned by **Monday 29 March** so that they can be considered as part of the pre-submission design and development phase.

Once the planning application is formally submitted, there will be a formal consultation period led by the South Gloucestershire Council planning team and you will have a further opportunity to comment on the scheme before any formal decisions are made.

If you have any further queries about this consultation, or would like a printed copy of the consultation material and survey, please contact Avril Baker Consultancy at info@abc-pr.co.uk or 0117 977 2002.

Best wishes



Avril Baker, Avril Baker Consultancy

Consultation co-ordinator on behalf of ISG, the Department for Education and The Enable Trust

Two Bridges Academy location map





Site plan

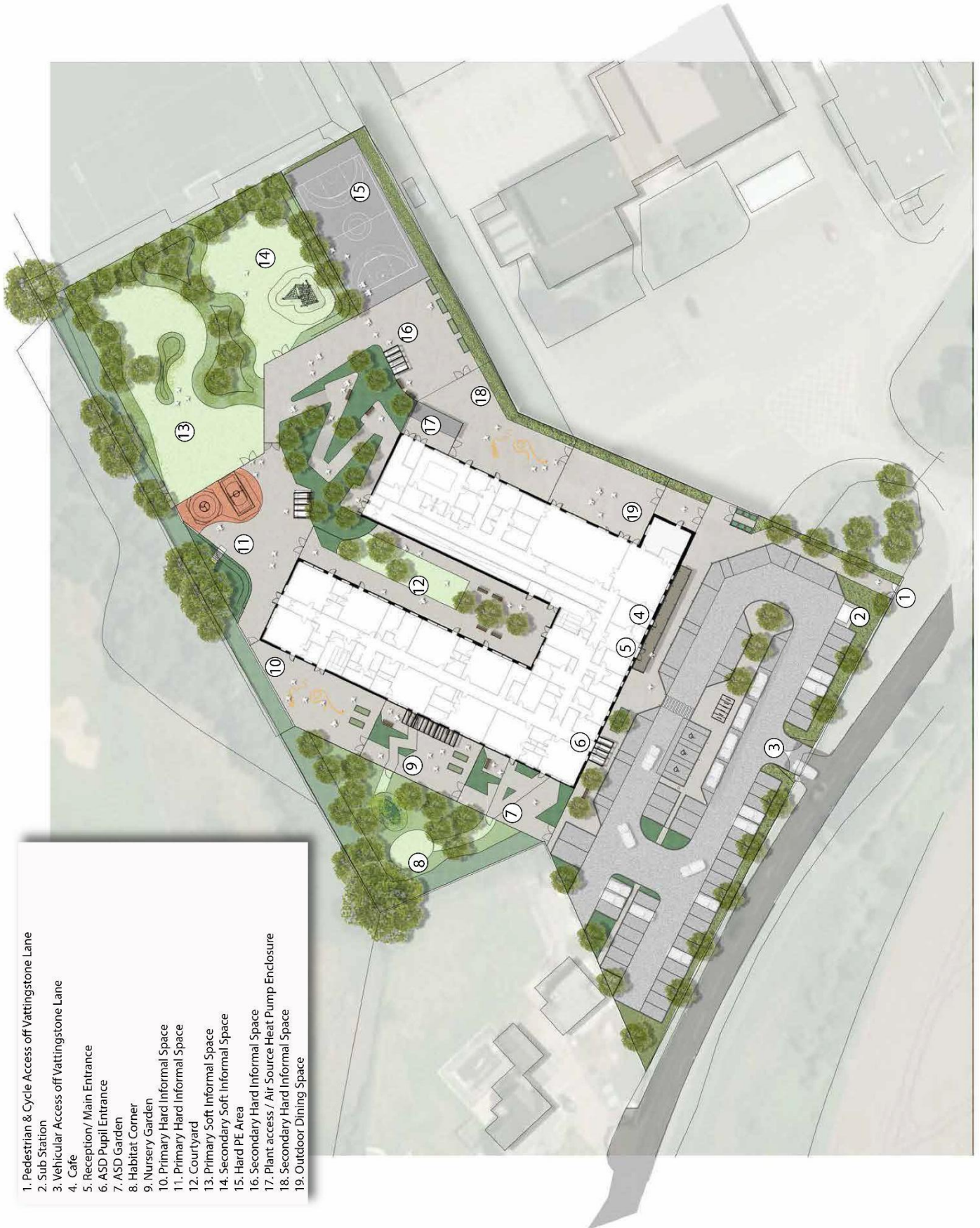

- 1. Pedestrian & Cycle Access off Vattlingstone Lane
- 2. Sub Station
- 3. Vehicular Access off Vattlingstone Lane
- 4. Cafe
- 5. Reception/ Main Entrance
- 6. ASD Pupil Entrance
- 7. ASD Garden
- 8. Habitat Corner
- 9. Nursery Garden
- 10. Primary Hard Informal Space
- 11. Primary Hard Informal Space
- 12. Courtyard
- 13. Primary Soft Informal Space
- 14. Secondary Soft Informal Space
- 15. Hard PE Area
- 16. Secondary Hard Informal Space
- 17. Plant access / Air Source Heat Pump Enclosure
- 18. Secondary Hard Informal Space
- 19. Outdoor Dining Space

Artist's impressions

The main entrance



Aerial view

